

Guide for automated lanes (with iris/fingerprint capturing)

01



Insert passport with
biodata page face down
on the reader

02



Remove passport when
prompted

03



Enter lane when the
flappers open and
remove cap, spectacles
and mask

04



Look between blue
arrows for iris scanning

05

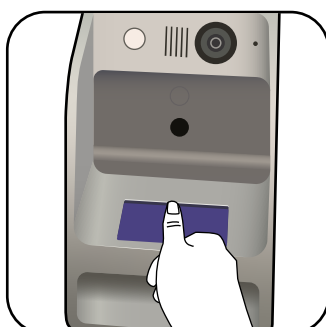

If prompted, place right
thumb on the scanner

06



Exit lane when the
flappers open



ICA
Securing Our Borders,
Safeguarding Our Home